



*PROTECTION & RELIABILITY  
OPTIMIZATION INSTRUMENTS*

A CTC COMPANY

# P R O D U C T M A N U A L

## Reverse Mount Proximity Probe Housing



**CE**  
Certified

**DM91000 Series**

# C O N T E N T S

---

SECTION 1: OVERVIEW.....	4
Introduction.....	4
Product Selection Guide.....	4
Specifications.....	5
Environmental.....	5
Physical.....	5
SECTION 2: OPERATION.....	6
Operating Procedure.....	6
SECTION 3: TROUBLESHOOTING.....	10
SECTION 4: MAINTENANCE.....	11
Maintenance.....	11
General.....	11
Warranty.....	11

# FIGURES

---

Figure 1 - Product Selectin Guide .....	4
Figure 2 - Housing Dimensions.....	5
Figure 3 - Probe installation into Sleeve .....	6
Figure 4 - Sleeve installation into housing .....	6
Figure 5 - Extension cable installation .....	7
Figure 6 - Gap Adjustment .....	7
Figure 7 - Coupling Nut .....	8
Figure 8 - Hex Nut .....	8
Figure 9 - Lid Installation.....	9
Figure 10 - Completed Installation.....	9

# SECTION 1 : OVERVIEW

## Introduction

This document contains information on the operation, installation and maintenance of the reverse mount proximity probe housing. The PRO DM91000 series housing protects important proximity probe instruments in harsh manufacturing conditions. Easily adjust the gap between the machine shaft and probe or replace an extension cable without shutting down a machine.

## Product Selection Guide

**DM91000** - 

Probe Option	Cable Length Option	Standoff Adapter	Penetration Option	Fitting Option	Mounting Option
00 = No Probe 16 = 8 mm Probe Included 26 = FFv Probe Included 29 = 11 mm Probe Included  <small>NOTE: If option 29, Cable Length Option must be 10</small>	00 = No Probe 05 = 0.5 meter 10 = 1.0 meter	00 = No Standoff 02 = 2.0 in 03 = 3.0 in 04 = 4.0 in 05 = 5.0 in  <small>NOTE: 7.5 in Max Length</small>	022 = 2.2 in 032 = 3.2 in 042 = 4.2 in 052 = 5.2 in 062 = 6.2 in 072 = 7.2 in 082 = 8.2 in 102 = 10.2 in 112 = 11.2 in 122 = 12.2 in  <small>NOTE: adjustment range of ±0.75 in. Longer length options available upon request.</small>	00 = No Fitting Two Hole Seals  03 = One 3/4-14 NPT Plug; One 3/4-14 to 1/2-14 NPT reducer; one cable seal grip  04 = One 3/4-14 NPT plug only	02 = 3/4 - 14 NPT  

Figure 1 - Product Selectin Guide

# SECTION 1: OVERVIEW

## Specifications

### Environmental

Temperature Range: -31°F(-35°C) to 350°F(177°C)

### Physical

#### Materials:

Housing	Aluminum
Sleeve	316L SST

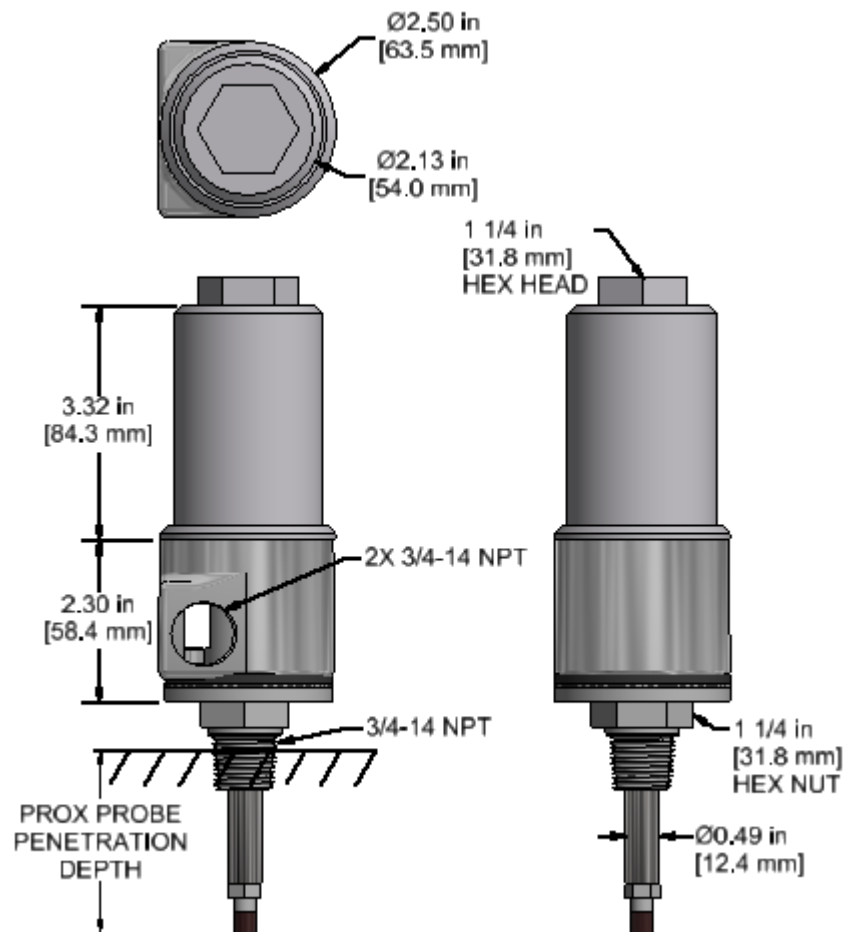

Figure 2 - Housing Dimensions

## SECTION 2: OPERATION

---

### Mounting Instructions

1. Mount base onto machine via  $\frac{3}{4}$ -14 NPT mounting thread.
2. Insert reverse mount probe into SST sleeve.



Figure 3 - Probe installation into Sleeve

3. Insert sleeve into housing.

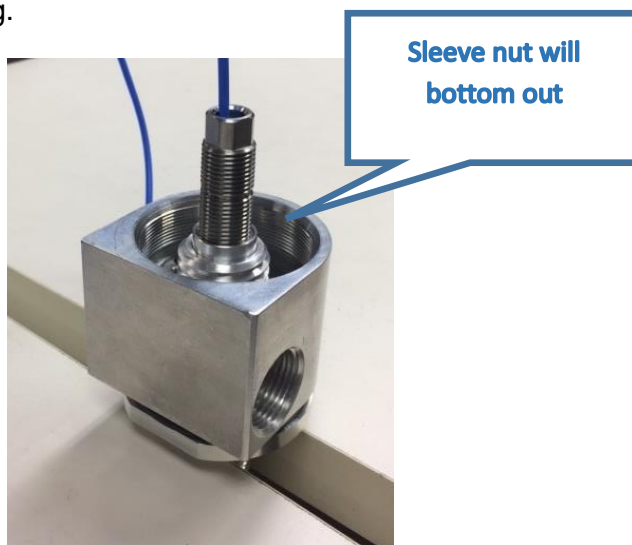
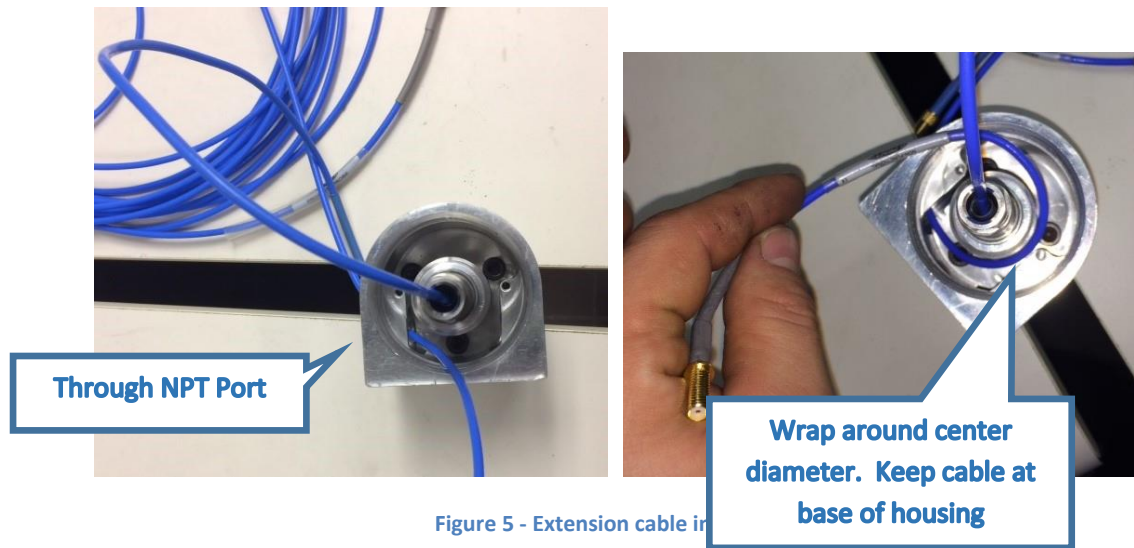

Figure 4 - Sleeve installation into housing

## SECTION 2 : OPERATION

---

4. Run Extension cable into housing through one of the two  $\frac{3}{4}$ -14 NPT ports.



5. Gap probe by adjusting the sleeve nut.

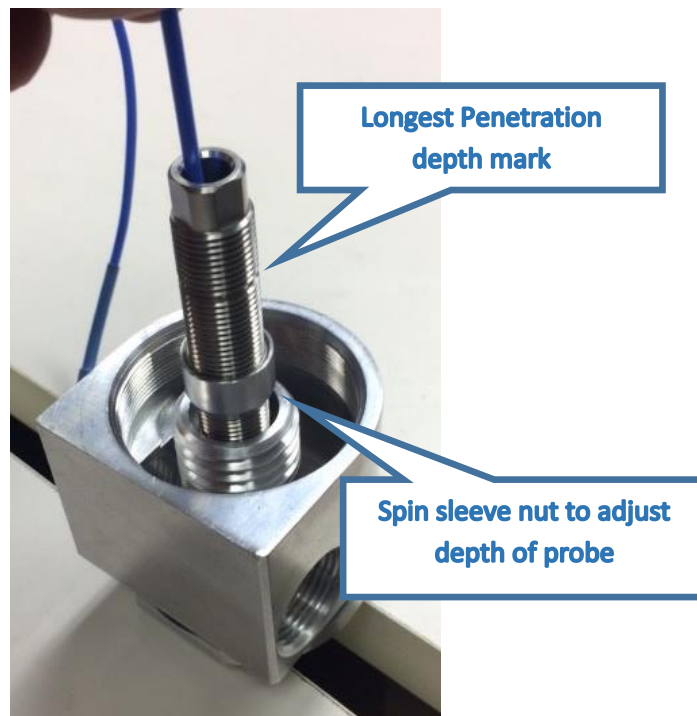

Figure 6 - Gap Adjustment

## SECTION 2: OPERATION

---

6. Tighten down coupling nut onto probe.

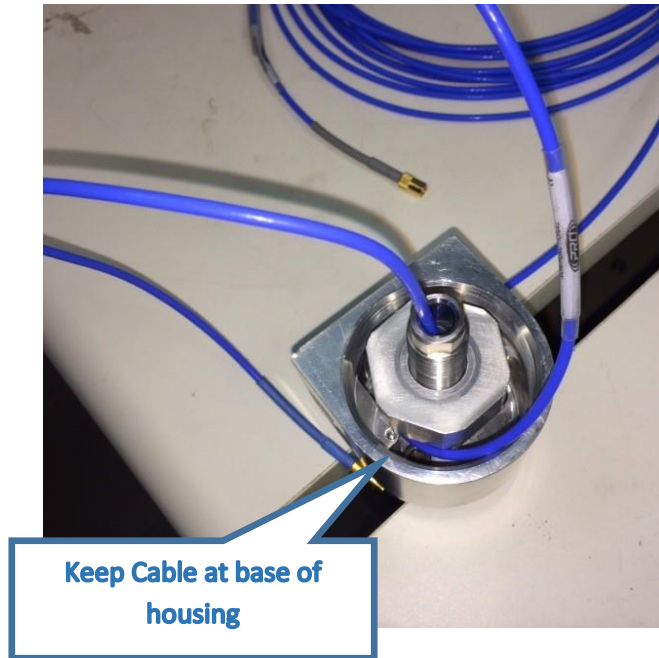

Figure 7 - Coupling Nut

7. Tighten down hex nut onto coupling nut.



Figure 8 - Hex Nut



## SECTION 2: OPERATION

---

8. Bundle cable and push into lid.

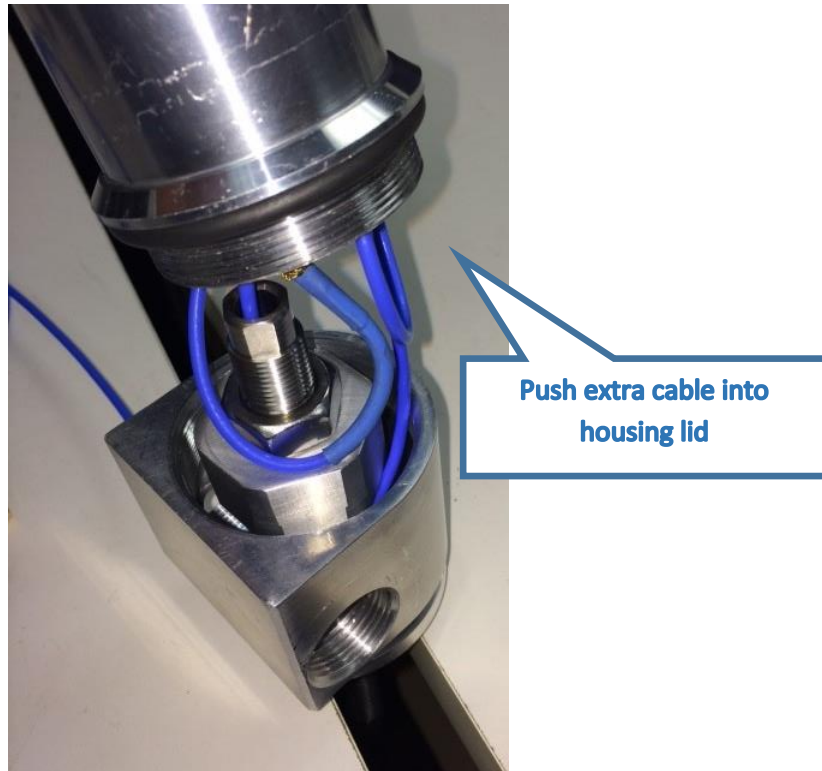

Figure 9 - Lid Installation

9. Tighten down lid onto housing.



Figure 10 - Completed Installation

## SECTION 3 : TROUBLESHOOTING

---

**Note:** For specific problem resolution, please call an Applications Engineer at 1-800-999-5290.

## **S E C T I O N   4 :   M A I N T E N A N C E**

---

### **Maintenance**

Once the DM91000 housing has been installed, minimal maintenance will be required. Basic visual checks to ensure integrity should be made periodically.

### **General**

There are no customer replaceable parts. The DM91000 housing has been designed for trouble – free service under normal operating conditions.

### **Warranty**

If any PRO product should ever fail, we will repair or replace it at no charge, as long as the product was not subjected to misuse, natural disaster, improper installation or modification which caused the defect.